

MOTORIZING KIT FOR SAWYER BEVELING MACHINES

- Fits all Compact, Quick-set and Band-type beveling transmissions
- Industrial grade fully-enclosed gear motor for durability and long life
- Increased speed control range allows flame or plasma cutting
- Extension cords and plugs are water resistant per IP 67 and are arctic and flame resistant
- Cast aluminum motor mount increases durability and rigidity
- High visibility yellow polyamide control box with integrated handle
- Shielded magnet included on the control box for attachment to pipe during use



SAWYER MFG. COMPANY

1031 N. Columbia Place • Tulsa, Oklahoma 74110 U.S.A.

Phone: (918) 834-2550 • Fax: (918) 834-0318

E-Mail: info@sawyerfmfg.com

Web Site: www.sawyerfmfg.com

BEVELING TRANSMISSION MOTORIZING KIT - MODEL 206F

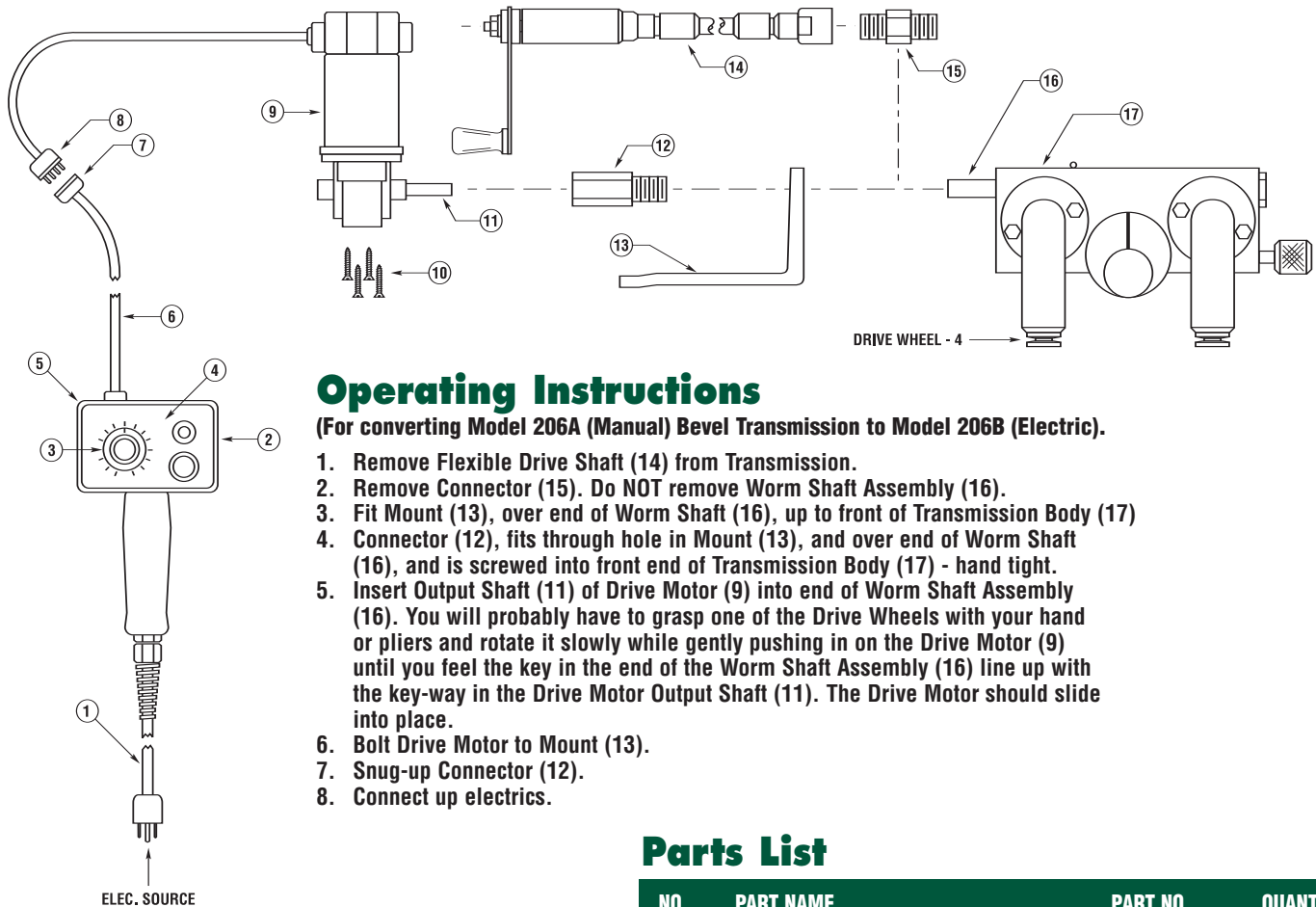

Operating Instructions

(For converting Model 206A (Manual) Bevel Transmission to Model 206B (Electric).

1. Remove Flexible Drive Shaft (14) from Transmission.
2. Remove Connector (15). Do NOT remove Worm Shaft Assembly (16).
3. Fit Mount (13), over end of Worm Shaft (16), up to front of Transmission Body (17)
4. Connector (12), fits through hole in Mount (13), and over end of Worm Shaft (16), and is screwed into front end of Transmission Body (17) - hand tight.
5. Insert Output Shaft (11) of Drive Motor (9) into end of Worm Shaft Assembly (16). You will probably have to grasp one of the Drive Wheels with your hand or pliers and rotate it slowly while gently pushing in on the Drive Motor (9) until you feel the key in the end of the Worm Shaft Assembly (16) line up with the key-way in the Drive Motor Output Shaft (11). The Drive Motor should slide into place.
6. Bolt Drive Motor to Mount (13).
7. Snug-up Connector (12).
8. Connect up electrics.

Parts List

NO.	PART NAME	PART NO.	QUANTITY
1A	110V Power Cord (Shown)	525-1	1
1B	220V Power Cord	525-46	1
2	Yellow Box Shell	525-38	1
2A	110V Speed Control Box	4HK	1
2B	220V Speed Control Box	4HL	1
3	Knob	525-44	1
4A	110 Decal	55T-1	1
4B	220V Decal	55T-2	1
5	Magnet (Not Shown)	525-59	1
6	Extension Cord	525-46	1
7	Female Plug	4HM	1
8	Male Plug	4HN	1
9	Drive Motor	525-37	1
10	Screw	515-33	4
11	Output Shaft	114J-3A	1
12	Connector	114J-2	1
13	Mount	114S	1
14	Flexible Drive Shaft	29CA	1
15	Connector	93B-1	1
16	Worm Shaft Assembly	4DA	1
17	Trans Body (Bevel Crawler)	206A	1



SAWYER MFG. COMPANY

1031 N. Columbia Place • Tulsa, Oklahoma 74110 U.S.A.

Phone: (918) 834-2550 • Fax: (918) 834-0318

E-Mail: info@sawyerfmfg.com

Web Site: www.sawyerfmfg.com